

Datum 23.000m

South East Elevation



Datum 23.000m

North East Elevation

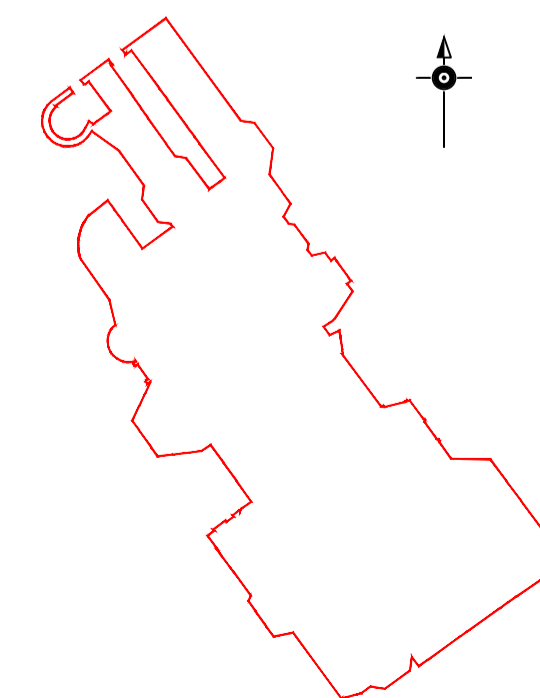

NORTHPOINT
This survey grid is based on arbitrary co-ordinates and the Northpoint is indicative only

LEVELS
Levels are related to a Ordnance Survey Spot Height Value 23.77m located in the junction of Rectory Lane and Manor Road

Digital Terrain Surveys LLP
Land Survey Partnership

Client	
Location Manor House Hotel	
Type of Survey Elevations	
Plotted Scale 1:50	Date March 2012
Ref No	Q & Checked
Drawing Number	of Revisions